

PARKING TABULATION		REQUIRED	PROPOSED
STAFF		140	154
SERVICE PERSONNEL		10	10
VISITORS		10	30
TOTAL		160	192
HANDICAPPED PARKING (INCLUDED IN ABOVE TOTAL)		6	10

SITE KEYNOTE	
[Pattern]	ALUMINUM CANOPY
[Pattern]	COVERED EXTERIOR / OVERHANG
[Pattern]	NEW CONCRETE SIDEWALK / PAVING
[Pattern]	PROPERTY LINE

- SITE KEYNOTE LEGEND**
- (A) MAIN SCHOOL SIGN - SEE DETAIL 05/A0.D.1
 - (B1) INFORMATIONAL SIGN TYPE B1
 - (B2) INFORMATIONAL SIGN TYPE B2
 - (B3) INFORMATIONAL SIGN TYPE B3
 - (C) NOT USED
 - (D) FLAGPOLE - SEE DETAIL 09/A0.D.1
 - (E) ITV TOWER
 - (F1) FIRE HYDRANT
 - (F2) "NO PARKING FIRE LANE" STRIPING W/ CURBSIDE SIGNS @ 60'-0" O.C.
 - (F3) FDC
 - (F4) DDCA
 - (F5) BFP
 - (F6) 20' WIDE FIRE DEPARTMENT ACCESS ROAD - STABILIZED SUBGRADE PROVIDE F.D.P. MARKERS AT 75' O.C. AND SIGNAGE STATING "FIRE DEPARTMENT ACCESS ONLY"
 - (G) ALUMINUM WALKWAY COVER
 - (H) BOLLARD - SEE DETAIL 13/A0.D.1
 - (J) DUMPSTER ENCLOSURE - SEE DRAWING A1.1.4.1
 - (K) KINEX BOX
 - (L) IRRIGATION PUMP
 - (M) CHAIR SEAT WALL - SEE DETAIL 12/A0.D.2
 - (N) MECHANICAL EQUIPMENT ON CONCRETE SLAB
 - (P) PAD MOUNTED ELECTRICAL TRANSFORMER
 - (R) FIRE DEPARTMENT ACCESS SIGN
 - (S) BURIED LP TANK(S)
 - (W) CONCRETE SIDEWALK - NUMBER FOLLOWING "W" DEFINES WIDTH OF SIDEWALK IN FEET

宋
Song + Associates
 Architects • Planners • Interior Design
 400 Amsterdam Ave. 8th Floor
 West 79th Street, Suite 2061
 New York, NY 10023
 Telephone: 212-633-3422
 Fax: 212-633-1422
 AA - 0001165 EB - 0001095
 Serial #:

Name: Thomas P. Kastner
 License #: 0015877
 Consultants:

The School District
 of
 Palm Beach County

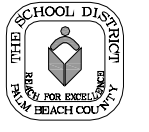

WELLINGTON AREA
 MIDDLE SCHOOL
 02-JJ

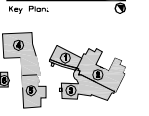

Revisions:
 4-20-05 ADDITION #2
 6-23-05 AS #1

Date: 3/1/05
 S+A Proj. No: 03116
 Owner Proj. No: 3371-8290
 Drawn By: 9H/SH
 Checked By: TK

Phase:
 100% CONSTRUCTION DOCUMENTS

Sheet Title:
 OVERALL SITE PLAN

Sheet #:
 A0.0.2

OVERALL SITE PLAN

01
 SCALE: 1" = 50'-0"
 N
 0 20' 50' 100'
 GRAPHIC SCALE (IN FEET)
 1 inch = 50 feet